

**PROTECTION OF EXISTING TREES**

Existing trees are to be protected and maintained during the course of construction to AS4790 Protection of Tree on Development Sites. The contractor is to abide by council regulations relating to any trees nominated in DA approval, which will require all on-site trees to be provided with a 1800mm high fully supported chaimesh to minimise disturbance to existing ground conditions within the canopy drip line for the duration of construction works. "Tree Protection Zone" is to be attached to the protective fence.

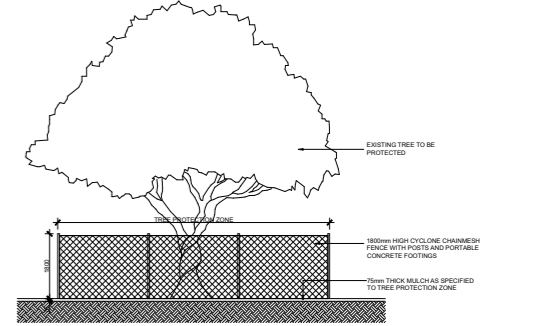

**TREE PROTECTION FENCING**

NTS

DENOTES LANDSCAPED AREA

DENOTES PEBBLED AREA

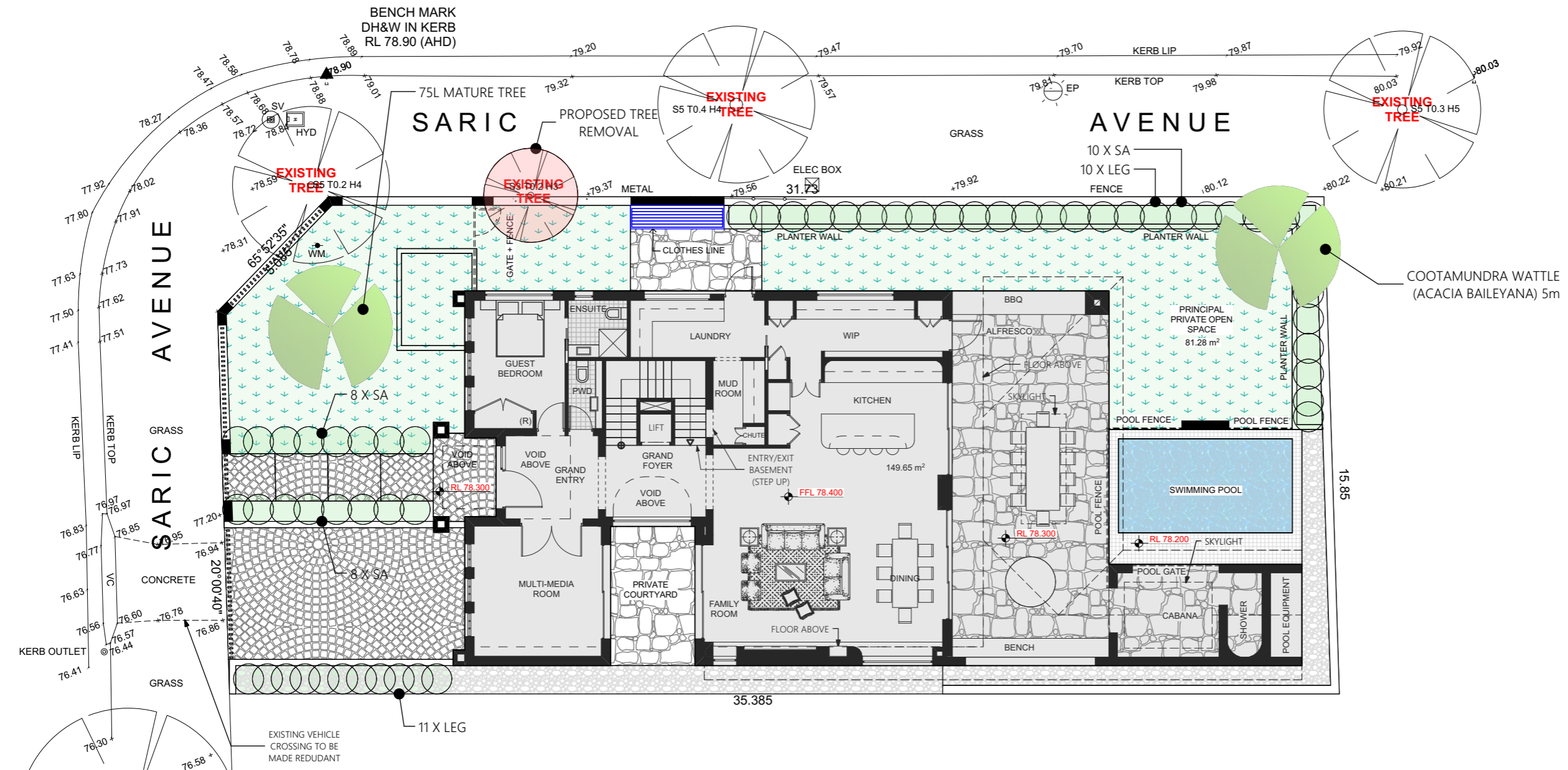
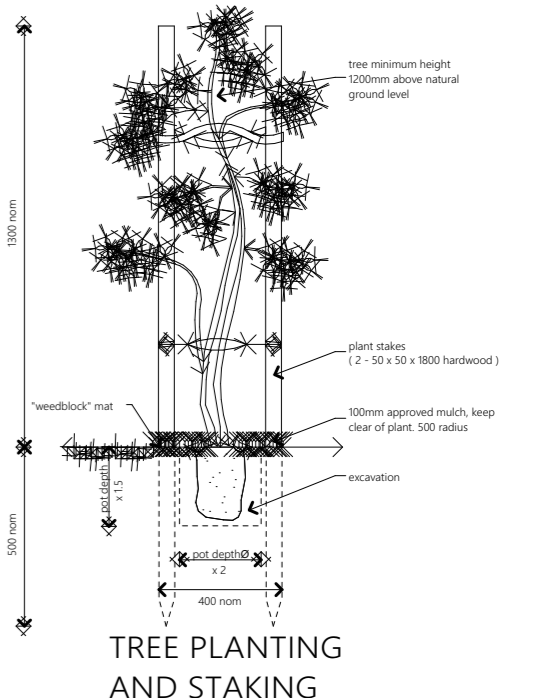

**1 LANDSCAPE PLAN**  
SCALE - NTS

**GENERAL NOTES:** All work to be carried out in accordance with the Building Code of Australia, Local and State Government Ordinances, relevant Australian Standards, Local Electricity and Water Authorities Regulations and all other relevant Authorities concerned. All structural work and site drainage to be subject to Engineer's details or certification where required by Council. This shall include r.c. slabs & footings, r.c. and steel beams and columns, wind bracing to AS 1170 & AS 4055, anchor bolts or bolts, tie down, fixing etc., driveway slabs and drainage to Council's satisfaction. All timbers to be in accordance with SAA Timber Structure Code AS1720 and SAA Timber Framing Code AS 1684. All work to be carried out in a professional and workmanship like manner.

**NOTE:** Do not scale off the drawings unless otherwise stated & use figured dimensions in preference.

All dimensions to be checked & verified by the CONTRACTOR on site before the commencement of any work, all dimensions and levels are subject to final survey & set-out. Discrepancies to be reported to designer prior to survey & set-out. Discrepancies to be reported to designer prior to commencement. No responsibility will be accepted by this firm for any variations in design, builder's method of construction or materials used, deviation from specification without permission or accepted work practices resulting in inferior construction. Locate and protect all services prior to construction.

**COPYRIGHT CLAUSE:** This drawing & design is the property of BEYONDVISIONDESIGN and should not be reproduced either in part or whole without the written consent of this firm. The information shown on it is regarded as confidential & must not be disclosed to any third party. This drawing must be returned upon request.

REV	DATE	DESCRIPTION	INITIAL
A	19.04.26	Issue for client review	HF
B	21.04.26	Issue for consultants	HF
C	26.04.26	Issue for development application	HF

**DRAWING TITLE:** Landscape Plan  
**DRAWN BY:** H. Fayad

LOT: 9 | SEC: - | DP: 238429  
**COUNCIL AREA:** COUNCIL CANTERBUYR-BANKSTOWN

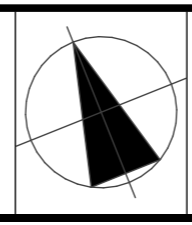

**SITE ADDRESS:** 6 Saric Avenue Georges Hall 2198  
**ISSUED FOR:** Issued for DA  
**PROJECT TYPE:** Proposed Dwelling over basement with pool

**SCALE:** As shown **DATE:** 03/2026 **REV:** A **SHEET NO:** 20

